

# YALÇIN GOLD BATTERY

## 10 OPzS 1000 (2V1000AH)

### Specification

Nominal Voltage	2V	
Capacity(10HR)	1000.0AH (1.8V/cell,20°C)	
Dimension	Length	233±2mm (9.17 inches)
	Width	210±3mm (8.27 inches)
	Container Height	646±3mm (25.4 inches)
	Total Height (with Terminal)	701±3mm (27.6 inches)
	Without Electrolyte	57.4 kg (126.3lbs)
Approx Weight	With Electrolyte	77.4 kg (170.3lbs)
	Container Material	SAN transparent container
Rated Capacity	1000.0 AH/100.0A	(10hr,1.80V/cell,25°C/77°F)
	888.0 AH/177.6A	(5hr,1.75V/cell,25°C/77°F)
	771.0 AH/257.0A	(3hr,1.75V/cell,25°C/77°F)
	571.0 AH/571.0A	(1hr,1.60V/cell,25°C/77°F)
Max. Discharge Current	8000A (5s)	
Internal Resistance	Approx 0.28mΩ	
Operating Temp.Range	Discharge	-15~50°C (5~122°F)
	Charge	0~40°C (32~104°F)
	Storage	-15~40°C (5~104°F)
Type and number of poles	M8/4	
Charging	Floating voltage: 2.23V~2.25V at 20°C(68°F)Temp.	
	Boost charge: 2.30V~2.40V at 20°C(68°F)Temp.	
	Charging current(max.): 0.1CA	
	Temp.Coefficient -3mV/°C	
Capacity affected by Temperature	40°C (104°F)	103%
	25°C (77°F)	100%
	0°C (32°F)	86%
Self Discharge (4% per month)	Gold OPzS batteries may be stored for up to 6 months at 20°C(68°F) and then a freshening charge is required. For higher temperatures the time interval will be shorter.	

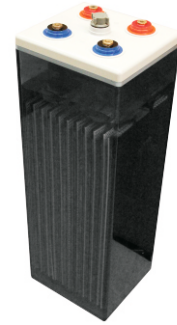

### Applications

- ◆ Telecommunications.
- ◆ Radio and cellular telephone relay stations.
- ◆ Emergency lighting systems.
- ◆ Power stations, Conventional power stations,
- ◆ Alternative power (solar, wind).
- ◆ Large UPS and computer back-up.
- ◆ Railway signalling.
- ◆ Maritime standby power on ships and ashore.
- ◆ Standby power.
- ◆ Buoy lighting.
- ◆ Long service life, designed life 15-20 years.

### Constant Current Discharge (Amperes) at 20 °C (68°F)

F.V/Time	30min	45min	1h	1.5h	2h	3h	4h	5h	6h	8h	10h	20h
1.60V/cell	758.0	658.7	571.0	450.0	372.0	278.0	223.5	189.0	163.6	129.5	106.9	58.0
1.65V/cell	712.0	633.3	552.0	438.7	363.5	273.3	220.3	186.5	161.4	127.9	105.7	57.5
1.70V/cell	676.0	597.3	531.0	424.7	355.0	265.3	215.3	182.4	158.3	125.6	104.0	56.7
1.75V/cell	634.0	569.3	504.0	404.7	340.0	257.0	208.8	177.6	154.5	123.6	102.2	55.7
1.80V/cell	564.0	513.3	464.0	379.3	319.5	244.0	199.9	170.3	148.8	120.2	100.0	54.7
1.85V/cell	450.0	425.3	397.0	337.3	290.0	223.3	184.9	159.6	140.2	114.2	95.7	52.6

### Constant Power Discharge (Watts) at 20 °C (68°F)

F.V/Time	30min	45min	1h	1.5h	2h	3h	4h	5h	6h	8h	10h	20h
1.60V/cell	1293.9	1152.7	1013.8	809.0	676.5	509.2	412.9	351.6	306.3	243.4	201.9	109.9
1.65V/cell	1241.8	1121.4	988.2	792.6	664.3	503.1	409.0	348.7	303.7	241.7	200.6	109.4
1.70V/cell	1195.2	1068.8	957.8	772.3	651.6	490.8	401.0	342.5	298.9	238.4	197.9	108.3
1.75V/cell	1139.8	1029.6	917.7	741.3	628.6	478.3	390.9	335.0	292.7	235.2	195.5	107.0
1.80V/cell	1027.7	942.4	855.7	702.9	596.0	457.6	376.5	322.7	283.6	230.0	192.3	105.5
1.85V/cell	833.9	792.2	742.9	633.6	547.0	423.3	351.9	305.0	269.2	220.3	185.6	102.3

Specifications subject to change without notice.



## Dimensions

### Terminal

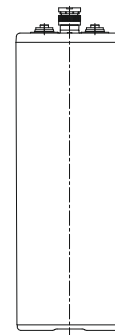
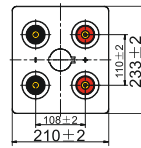
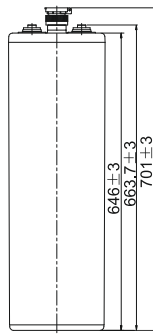
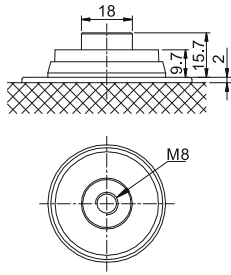

## Discharge Characteristics

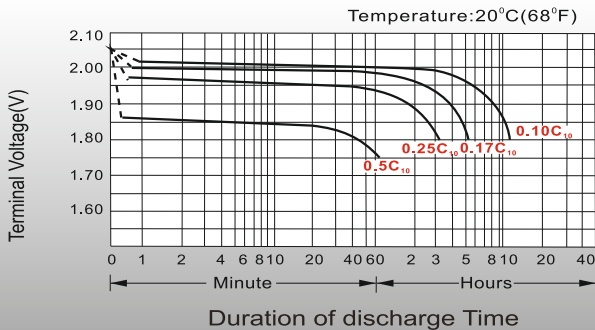

## Charge voltage Vs ambient temperature curve

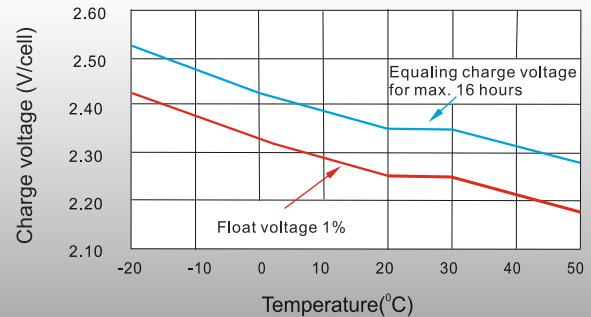

## Discharge capacity Vs Ambient temperature curve (I10A)

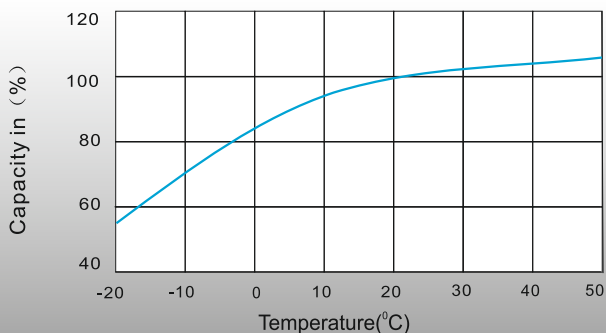

## Relation curves of service life and ambient temperature

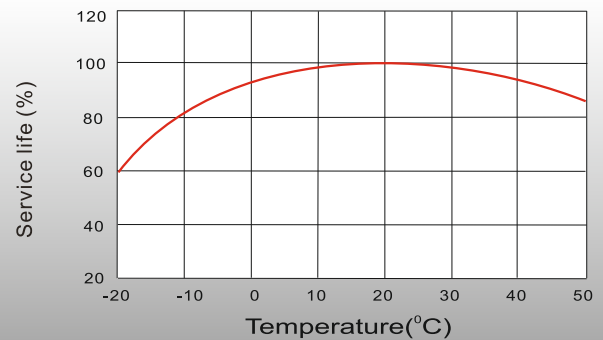

## Self Discharge Characteristics

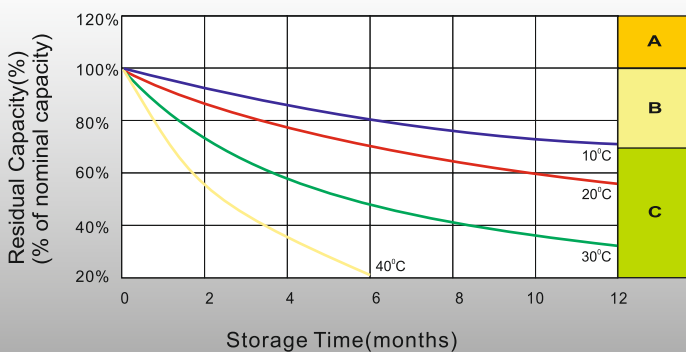

- A** No supplementary charge required  
(Carry out supplementary charge before use if 100% capacity is required.)
- B** Supplementary charge required before use. Optional charging way as below:
  1. Charged for above 3 days at limited current 0.1CA and constant voltage 2.25V/cell.
  2. Charged for above 20 hours at limited current 0.1CA and constant voltage 2.45V/cell.
  3. Charged for 8~10 hours at limited current 0.05CA.
- C** Supplementary charge may often fail to recover the capacity.  
The battery should never be left standing till this is reached.



Merkez

100. Yıl Bulvarı 1232. Sokak  
(Eski 40. Sokak) No: 65  
Ostim / ANKARA



Tel&Fax

T. (0.312) 354 16 45  
(0.312) 385 55 60  
F. (0.312) 354 07 97



Servis

100. Yıl Bulvarı 1234. Sokak  
(Eski 57. Sokak) No: 91  
Ostim / ANKARA



Fabrika

Kırıkkale OSB Kızılırmak Caddesi  
4. Sokak No: 6  
Yahşihan / KIRIKKALE