

# YALÇIN

# GOLD

## BATTERY

## GDC12045.0 (12V45AH)

### GENERAL FEATURES

- ◆ Oxygen recombination technology: maintenance-free, no need to add water or acid
- ◆ The patent grid alloy: less gassing, low self-discharge, excellent corrosion resistance
- ◆ Long life, low self-discharge rate and high reliability, deep discharge recoverability
- ◆ High quality AGM separator: extend cycle life and prevent micro short circuit
- ◆ ABS container: increase the strength of battery (Flame-retardant ABS UL94-V0 is optional)

### Dimension

Unit:mm

Length	198.5±2mm / 7.81inch
Width	166±2mm / 6.54inch
Container Height	169.5±3mm / 6.67inch
Total Height	169.5±3mm / 6.67inch

### Application

- ◆ Electric tools or toys
- ◆ Electric Bicycle/Tricycle
- ◆ Golf trolleys and golf cart
- ◆ Patrol car
- ◆ Electric Sight-seeing Tour Bus
- ◆ Sweeper
- ◆ Wheelchairs
- ◆ Lawn mowers
- ◆ Illumination light

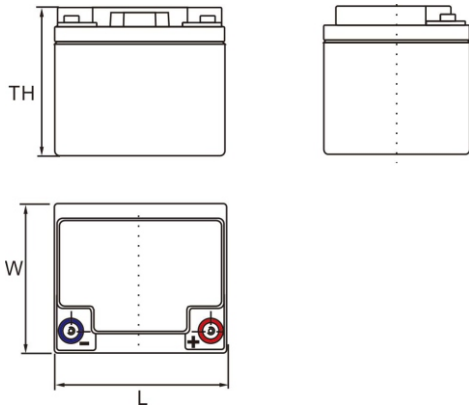

### Terminal

Unit:mm

Terminal Type: I3

### Weight

14.5kg 32.06lbs

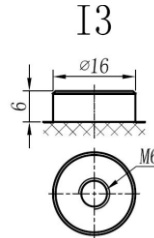

**Merkez**

100. Yıl Bulvarı 1232. Sokak  
(Eski 40. Sokak) No: 65  
Ostim / ANKARA

**Tel&Fax**

T. (0.312) 354 16 45  
(0.312) 385 55 60  
F. (0.312) 354 07 97

**Servis**

100. Yıl Bulvarı 1234. Sokak  
(Eski 57. Sokak) No: 91  
Ostim / ANKARA

**Fabrika**

Kırıkkale OSB Kızılırmak Caddesi  
4. Sokak No: 6  
Yahşihan / KIRIKKALE

# YALÇIN GOLD BATTERY

## Specifcaion

<b>Nominal Voltage</b>	12V
<b>Rated Capacity(25°C)</b>	45Ah 20hr Rate(1.80V/cell ) 42Ah 10hr Rate(1.80V/cell ) 37Ah 5hr Rate(1.75V/cell ) 35Ah 3hr Rate(1.70V/cell ) 26Ah 1hr Rate(1.60V/cell )
<b>Container Material</b>	ABS ( Flame-retardant ABS UL94-V0 is optional )
<b>Operating Temperature Range</b>	<b>Discharge</b> -20 ~ +50°C <b>Charge</b> 0 ~ +40°C <b>Storage</b> -15 ~ +40°C
<b>Capacity Effected by Temperature</b>	40°C / 104°F 106% 25°C / 77°F 100% 0°C / 32°F 86% -10°C / 14°F 65%
<b>Charge</b>	<b>Float Voltage</b> 2.23 -2.27V/cell@25°C, Tem.Coefficient : -3mV/cell/°C <b>Equalize Voltage</b> 2.35 -2.40V/cell@25°C, Tem.Coefficient : -3mV/cell/°C <b>Cycle Voltage</b> 2.40 -2.50V/cell@25°C, Tem.Coefficient : -5mV/cell/°C
<b>Max. Charging Current</b>	12.6A ( 0.3C )
<b>Max. Discharge Current (5'</b>	540A
<b>Internal Resistance</b>	9mΩ
<b>Monthly Self Discharge</b>	<3%, GDC series stored at 25°C require a supplementary charge every six months, the charging interval would shrink when the ambient temperature went higher

## Discharge Performance

Constant Current Discharge Table (25°C/77°F)Unit: A														
F.V/Time	10min	15min	20min	30min	45min	1h	2h	3h	4h	5h	6h	8h	10h	20h
1.85V/cell	49.1	41.3	36.7	30.4	23.9	20.40	13.20	9.92	8.13	6.84	5.96	4.78	4.074	2.172
1.80V/cell	56.3	46.4	40.5	33.0	25.7	21.52	14.21	10.66	8.64	7.25	6.31	5.03	4.204	2.252
1.75V/cell	64.0	52.4	44.8	35.9	28.0	23.45	14.72	11.06	8.93	7.42	6.51	5.20	4.314	2.302
1.70V/cell	72.2	58.1	49.5	39.2	30.1	24.77	15.53	11.67	9.34	7.85	6.83	5.42	4.484	2.362
1.67V/cell	77.6	62.2	52.7	41.4	32.0	25.68	16.14	12.18	9.70	8.09	7.06	5.61	4.605	2.442
1.60V/cell	85.3	68.2	57.2	44.1	33.2	26.39	16.54	12.48	9.92	8.29	7.21	5.70	4.705	2.482

Constant Power Discharge Table (25°C/77°F) Unit: W														
F.V/Time	10min	15min	20min	30min	45min	1h	2h	3h	4h	5h	6h	8h	10h	20h
1.85V/cell	91.9	78.0	69.9	58.7	45.6	39.14	25.53	19.22	15.82	13.31	11.71	9.45	8.148	4.344
1.80V/cell	103.9	86.5	76.2	62.7	48.8	41.14	27.23	20.62	16.72	14.11	12.41	9.92	8.388	4.494
1.75V/cell	116.1	96.3	83.4	67.6	52.8	44.64	28.23	21.32	17.22	14.41	12.71	10.21	8.609	4.605
1.70V/cell	128.2	105.3	91.4	73.4	56.7	47.05	29.73	22.42	18.02	15.22	13.31	20.62	8.929	4.715
1.67V/cell	136.4	111.9	96.5	76.8	59.4	48.35	30.63	23.22	18.62	15.62	13.71	11.01	9.169	4.855
1.60V/cell	146.6	120.5	103.7	81.4	61.4	49.55	31.23	23.72	19.02	15.92	14.01	11.11	9.339	4.925



Merkez

100. Yıl Bulvarı 1232. Sokak  
(Eski 40. Sokak) No: 65  
Ostim / ANKARA



Tel&Fax

T. (0.312) 354 16 45  
(0.312) 385 55 60  
F. (0.312) 354 07 97



Servis

100. Yıl Bulvarı 1234. Sokak  
(Eski 57. Sokak) No: 91  
Ostim / ANKARA



Fabrika

Kırıkkale OSB Kızılırmak Caddesi  
4. Sokak No: 6  
Yahşihan / KIRIKKALE