

YALÇIN

GOLD

BATTERY

GDC12055.0 (12V55AH)

GENERAL FEATURES

- ◆ Oxygen recombination technology: Maintenance Free VRLA Battery, no need to add water or acid
- ◆ The patent grid alloy: less gassing, low self-discharge, excellent corrosion resistance performance
- ◆ Special paste formula: additives are added to improve deep discharge, long cycle life
- ◆ High quality AGM separator: extend cycle life and prevent micro short circuit
- ◆ The patent Nano silica gel electrolytes, extend cycle life and improve the deep discharge performance
- ◆ ABS container: increase the strength of battery (Flame-retardant ABSUL94-V0 is optional)

Dimension

Unit:mm

Length	224±2mm	/	8.82inch
Width	135±2mm	/	5.31inch
Container Height	178±2mm	/	7.01inch
Total Height	178±2mm	/	7.01inch

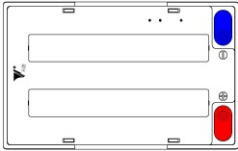
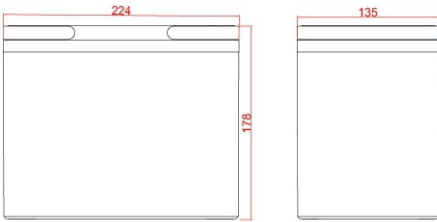

Application

- ◆ Electric tools or toys
- ◆ Electric Bicycle/Tricycle
- ◆ Golf trolleys and golf cart
- ◆ Patrol car
- ◆ Electric Sight-seeing Tour Bus
- ◆ Sweeper
- ◆ Wheelchairs
- ◆ Lawn mowers
- ◆ Illumination light

Terminal

Unit:mm

Terminal Type: I1

Weight

17.1kg

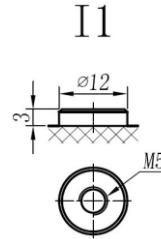

 **Merkez**

100. Yıl Bulvarı 1232. Sokak
(Eski 40. Sokak) No: 65
Ostim / ANKARA

 **Tel&Fax**

T. (0.312) 354 16 45
(0.312) 385 55 60
F. (0.312) 354 07 97

 **Servis**

100. Yıl Bulvarı 1234. Sokak
(Eski 57. Sokak) No: 91
Ostim / ANKARA

 **Fabrika**

Kırıkkale OSB Kızılırmak Caddesi
4. Sokak No: 6
Yahşihan / KIRIKKALE

YALÇIN GOLD BATTERY

Specificaion

Nominal Voltage	12V
Nominal Capacity	59Ah
Rated Capacity	C20(1.80V/cell) 59Ah
Capacity (25°C)	C10(1.80V/cell) 56Ah C5(1.75V/cell) 53Ah
Container Material	ABS (Flame-retardant ABSUL94-V0 is optional)
Operating Temperature Range	Discharge -20 ~ +50°C Charge 0 ~ +40°C Storage -15 ~ +40°C
Capacity Effected by Temperature	40°C / 104°F 106% 25°C / 77°F 100% 0°C / 32°F 86% -10°C / 14°F 65%
Charge Method	Please refer to the "Charge Characteristics (25°C)" below
Monthly Self Discharge	<3%, GDC series stored at 25°C require a supplementary charge every six months, the charging interval would shrink when the ambient temperature went higher

Performance Curve

Discharge Characteristics (25°C)

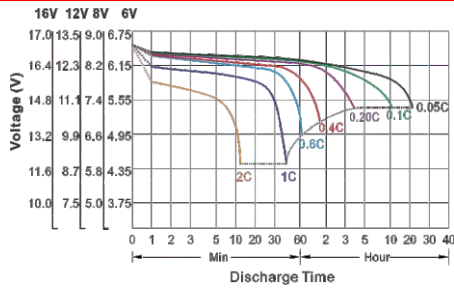

Charge Characteristics (25°C)

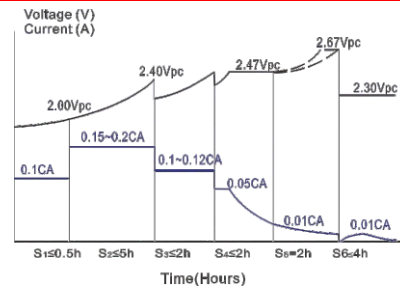

Cycle Lives With Depth Of Discharge

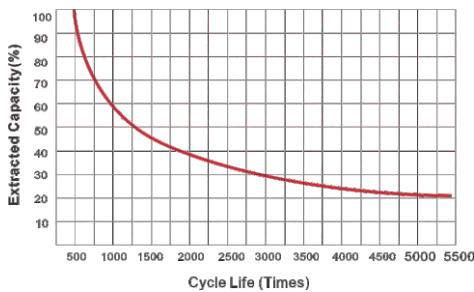

Self-Discharge Characteristics

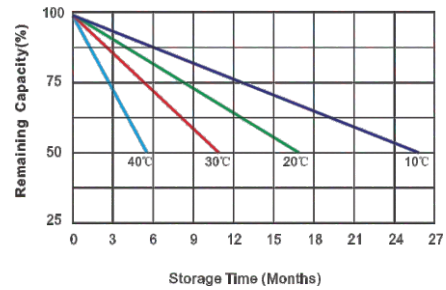

Merkez

100. Yıl Bulvarı 1232. Sokak
(Eski 40. Sokak) No: 65
Ostim / ANKARA

Tel&Fax

T. (0.312) 354 16 45
(0.312) 385 55 60
F. (0.312) 354 07 97

Servis

100. Yıl Bulvarı 1234. Sokak
(Eski 57. Sokak) No: 91
Ostim / ANKARA

Fabrika

Kırıkkale OSB Kızılırmak Caddesi
4. Sokak No: 6
Yahşihan / KIRIKKALE