

YALÇIN GOLD BATTERY

YGG12120.0 (12V120AH)

GENERAL FEATURES

- ◆ Oxygen recombination technology: maintenance-free, no need to add water or acid
- ◆ The patent grid alloy: less gassing, low self-discharge, excellent corrosion resistance
- ◆ Special paste formula: additives for deep discharge, long cycle life
- ◆ High quality AGM separator: extend cycle life and prevent micro short circuit
- ◆ The patent Nano silica electrolytes, extend cycle life and improve the deep discharge performance
- ◆ ABS container: increase the strength of battery (Flame-retardant ABS UL94-V0 is optional)

Application

- ◆ Renewable energy system
- ◆ Hybrid solar power system
- ◆ Uninterrupted Power Supply (UPS)
- ◆ Communications and electric equipment
- ◆ Emergency lighting equipment
- ◆ Fire alarm and security systems
- ◆ Robots, control equipment, and other factory automation equipment
- ◆ Emergency power supply (EPS)
- ◆ Various power toy and hobby equipment
- ◆ Lighting equipment

Dimension

Unit:mm

Length	406±2mm	/	15.98inch
Width	173±2mm	/	6.81inch
Container Height	209±3mm	/	8.23inch
Total Height	233±3mm	/	9.17inch

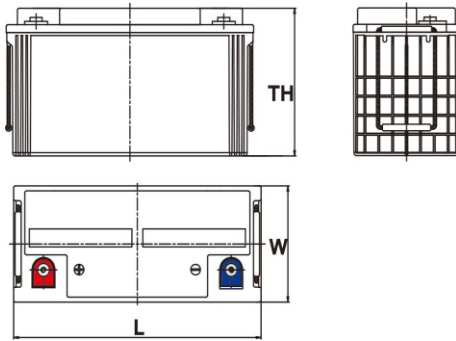

Terminal

Unit:mm

Terminal Type: I7

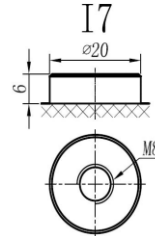

Weight

38.3kg 84.44lbs

 **Merkez**

100. Yıl Bulvarı 1232. Sokak
(Eski 40. Sokak) No: 65
Ostim / ANKARA

 **Tel&Fax**

T. (0.312) 354 16 45
(0.312) 385 55 60
F. (0.312) 354 07 97

 **Servis**

100. Yıl Bulvarı 1234. Sokak
(Eski 57. Sokak) No: 91
Ostim / ANKARA

 **Fabrika**

Kırıkkale OSB Kızılırmak Caddesi
4. Sokak No: 6
Yahşihan / KIRIKKALE

YALÇIN GOLD BATTERY

Specificaion

Nominal Voltage	12V
	127Ah 20hr Rate(1.80V/cell)
	120Ah 10hr Rate(1.80V/cell)
Rated Capacity(25°C)	103Ah 5hr Rate(1.75V/cell)
	96Ah 3hr Rate(1.70V/cell)
	73Ah 1hr Rate(1.60V/cell)
Container Material	ABS (Flame-retardant ABS UL94-V0 is optional)
Operating Temperature Range	Discharge -20 ~ +50°C
	Charge 0 ~ +40°C
	Storage -15 ~ +40°C
Capacity Effected by Temperature	40°C / 104°F 106%
	25°C / 77°F 100%
	0°C / 32°F 86%
	-10°C / 14°F 65%
Charge Voltage	Float Voltage 2.25 -2.30V/cell@25°C, Tem. Coefficient: -3mV/cell/°C
	Equalize Voltage 2.35 -2.40V/cell@25°C, Tem. Coefficient: -3mV/cell/°C
	Cycle Voltage 2.40 -2.50V/cell@25°C, Tem. Coefficient: -5mV/cell/°C
Max Charging Current	36A (0.3C)
Max. Discharge Current (5S)	1300A
Internal Resistance	4mΩ
Self Discharge	<3%. YG series stored at 25 °C require a supplementary charge every six months, the charging interval would shrink when the ambient temperature went higher

Discharge Performance

Constant Current Discharge Table (25°C/77°F) Unit: A

F.V/Time	5min	10min	15min	20min	30min	45min	1h	2h	3h	4h	5h	6h	8h	10h	20h
1.85V/cell	201.5	158.4	134.7	112.7	89.6	68.7	56.59	35.99	28.49	23.29	18.80	16.30	13.30	11.31	6.310
1.80V/cell	270.5	202.4	162.7	133.2	105.7	80.0	63.39	39.29	30.69	24.79	20.10	17.50	14.10	12.01	6.371
1.75V/cell	304.9	222.4	177.8	143.3	109.7	83.0	66.29	40.79	31.19	25.39	20.60	18.00	14.30	12.11	6.432
1.70V/cell	335.8	242.4	189.8	150.6	114.2	86.2	68.38	42.39	32.09	26.09	21.20	18.40	14.50	12.21	6.555
1.65V/cell	370.2	261.6	201.8	160.0	120.5	88.4	70.68	43.59	33.49	26.99	21.80	18.80	14.70	12.51	6.637
1.60V/cell	408.4	284.0	215.8	170.4	127.1	92.1	73.18	45.09	34.49	27.79	22.49	19.20	14.90	12.61	6.677

Constant Power Discharge Table (25°C/77°F) Unit: W

F.V/Time	5min	10min	15min	20min	30min	45min	1h	2h	3h	4h	5h	6h	8h	10h	20h
1.85V/cell	201.5	158.4	134.7	112.7	89.6	68.7	56.59	35.99	28.49	23.29	18.80	16.30	13.30	11.31	6.180
1.80V/cell	270.5	202.4	162.7	133.2	105.7	80.0	63.39	39.29	30.69	24.79	20.10	17.50	14.10	12.01	6.240
1.75V/cell	304.9	222.4	177.8	143.3	109.7	83.0	66.29	40.79	31.19	25.39	20.60	18.00	14.30	12.11	6.300
1.70V/cell	335.8	242.4	189.8	150.6	114.2	86.2	68.38	42.39	32.09	26.09	21.20	18.40	14.50	12.21	6.420
1.65V/cell	370.2	261.6	201.8	160.0	120.5	88.4	70.68	43.59	33.49	26.99	21.80	18.80	14.70	12.51	6.500
1.60V/cell	408.4	284.0	215.8	170.4	127.1	92.1	73.18	45.09	34.49	27.79	22.49	19.20	14.90	12.61	6.540

 **Merkez**

100. Yıl Bulvarı 1232. Sokak
(Eski 40. Sokak) No: 65
Ostim / ANKARA

 **Tel&Fax**

T. (0.312) 354 16 45
(0.312) 385 55 60
F. (0.312) 354 07 97

 **Servis**

100. Yıl Bulvarı 1234. Sokak
(Eski 57. Sokak) No: 91
Ostim / ANKARA

 **Fabrika**

Kırıkkale OSB Kızılırmak Caddesi
4. Sokak No: 6
Yahşihan / KIRIKKALE