

YALÇIN GOLD BATTERY

YGG12150.0 (12V150AH)

GENERAL FEATURES

- ◆ Oxygen recombination technology: maintenance-free, no need to add water or acid
- ◆ The patent grid alloy: less gassing, low self-discharge, excellent corrosion resistance
- ◆ Special paste formula: additives for deep discharge, long cycle life
- ◆ High quality AGM separator: extend cycle life and prevent micro short circuit
- ◆ The patent Nano silica electrolytes, extend cycle life and improve the deep discharge performance
- ◆ ABS container: increase the strength of battery (Flame-retardant ABS UL94-V0 is optional)

Dimension

Unit:mm

Length	482±2mm / 18.98inch
Width	170±2mm / 6.69inch
Container Height	240±3mm / 9.45inch
Total Height	240±3mm / 9.45inch

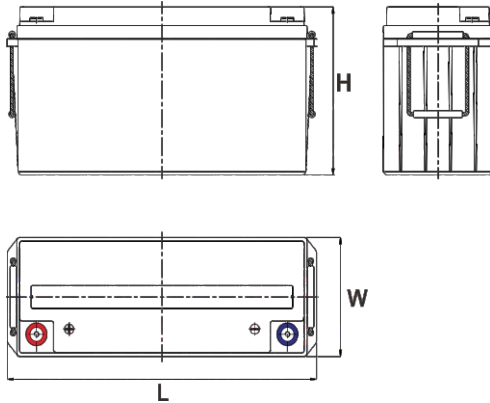

Application

- ◆ Renewable energy system
- ◆ Hybrid solar power system
- ◆ Uninterrupted Power Supply (UPS)
- ◆ Communications and electric equipment
- ◆ Emergency lighting equipment
- ◆ Fire alarm and security systems
- ◆ Robots, control equipment, and other factory automation equipment
- ◆ Emergency power supply (EPS)
- ◆ Various power toy and hobby equipment
- ◆ Lighting equipment

Terminal

Unit:mm

Terminal Type: I7

Weight

48kg 105.82lbs

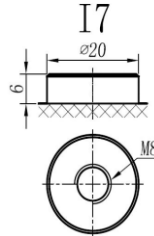

Merkez

100. Yıl Bulvarı 1232. Sokak
(Eski 40. Sokak) No: 65
Ostim / ANKARA



Tel&Fax

T. (0.312) 354 16 45
(0.312) 385 55 60
F. (0.312) 354 07 97



Servis

100. Yıl Bulvarı 1234. Sokak
(Eski 57. Sokak) No: 91
Ostim / ANKARA



Fabrika

Kırıkkale OSB Kızılırmak Caddesi
4. Sokak No: 6
Yahşihan / KIRIKKALE

YALÇIN GOLD BATTERY

Specificaion

Nominal Voltage	12V	
	159Ah	20hr Rate(1.80V/cell)
	150Ah	10hr Rate(1.80V/cell)
Rated Capacity(25°C)	129Ah	5hr Rate(1.75V/cell)
	120Ah	3hr Rate(1.70V/cell)
	91Ah	1hr Rate(1.60V/cell)
Container Material	ABS (Flame-retardant ABS UL94-V0 is optional)	
Operating Temperature Range	Discharge	-20 ~ +50°C
	Charge	0 ~ +40°C
	Storage	-15 ~ +40°C
Capacity Effected by Temperature	40°C / 104°F	106%
	25°C / 77°F	100%
	0°C / 32°F	86%
	-10°C / 14°F	65%
Charge Voltage	Float Voltage	2.25 -2.30V/cell@25°C, Tem. Coefficient: -3mV/cell/°C
	Equalize Voltage	2.35 -2.40V/cell@25°C, Tem. Coefficient: -3mV/cell/°C
	Cycle Voltage	2.40 -2.50V/cell@25°C, Tem. Coefficient: -5mV/cell/°C
Max Charging Current	45A (0.3C)	
Max. Discharge Current (5S)	1500A	
Internal Resistance	3.5mΩ	
Self Discharge	<3%, YG series stored at 25 °C require a supplementary charge every six months, the charging interval would shrink when the ambient temperature went higher	

Discharge Performance

Constant Current Discharge Table (25°C/77°F) Unit: A

F.V/Time	5min	10min	15min	20min	30min	45min	1h	2h	3h	4h	5h	6h	8h	10h	20h
1.85V/cell	251.8	198.0	168.3	140.9	111.9	85.9	70.68	44.99	35.59	29.09	23.49	20.40	16.60	14.21	7.892
1.80V/cell	338.0	253.0	203.5	166.5	132.0	99.9	79.18	49.19	38.29	31.09	25.19	21.90	17.60	15.02	7.964
1.75V/cell	381.1	278.0	222.2	179.1	137.1	103.6	82.88	50.99	38.99	31.79	25.79	22.50	17.90	15.12	8.046
1.70V/cell	419.8	303.0	237.2	188.3	142.7	107.8	85.48	52.99	40.09	32.59	26.49	23.00	18.10	15.32	8.199
1.65V/cell	462.8	327.0	252.3	199.9	150.6	110.5	88.38	54.49	41.79	33.69	27.19	23.50	18.40	15.62	8.301
1.60V/cell	/	355.0	269.8	213.0	158.9	115.2	91.48	56.29	43.09	34.79	28.09	24.00	18.60	15.82	8.352

Constant Power Discharge Table (25°C/77°F) Unit: W

F.V/Time	5min	10min	15min	20min	30min	45min	1h	2h	3h	4h	5h	6h	8h	10h	20h
1.85V/cell	460.5	365.7	314.2	265.5	213.4	162.8	134.49	86.27	68.43	56.10	45.36	39.74	32.41	28.03	15.300
1.80V/cell	611.5	461.8	374.5	309.2	247.9	188.0	149.87	93.47	73.26	59.55	48.41	42.51	34.29	29.63	15.400
1.75V/cell	674.8	499.3	404.1	329.4	255.3	193.2	156.08	96.63	74.34	60.64	49.60	43.50	34.78	29.93	15.600
1.70V/cell	722.5	531.9	425.4	343.6	264.2	200.1	160.42	100.27	76.22	62.12	50.68	44.40	35.28	30.23	15.800
1.65V/cell	785.4	568.8	448.8	362.3	276.4	203.3	164.66	102.44	79.08	64.09	51.96	45.19	35.77	30.73	16.000
1.60V/cell	/	603.4	472.0	381.8	289.8	210.7	169.59	105.40	81.15	65.86	53.44	46.08	35.97	31.03	16.100

 **Merkez**

100. Yıl Bulvarı 1232. Sokak
(Eski 40. Sokak) No: 65
Ostim / ANKARA

 **Tel&Fax**

T. (0.312) 354 16 45
(0.312) 385 55 60
F. (0.312) 354 07 97

 **Servis**

100. Yıl Bulvarı 1234. Sokak
(Eski 57. Sokak) No: 91
Ostim / ANKARA

 **Fabrika**

Kırıkkale OSB Kızılırmak Caddesi
4. Sokak No: 6
Yahşihan / KIRIKKALE