

# YALÇIN GOLD BATTERY

## YGG12200.0 (12V200AH)

### GENERAL FEATURES

- ◆ Oxygen recombination technology: maintenance-free, no need to add water or acid
- ◆ The patent grid alloy: less gassing, low self-discharge, excellent corrosion resistance
- ◆ Special paste formula: additives for deep discharge, long cycle life
- ◆ High quality AGM separator: extend cycle life and prevent micro short circuit
- ◆ The patent Nano silica electrolytes, extend cycle life and improve the deep discharge performance
- ◆ ABS container: increase the strength of battery (Flame-retardant ABS UL94-V0 is optional)

### Dimension

Unit:mm

Length	520±2mm / 20.47inch
Width	239±2mm / 9.41inch
Container Height	220±3mm / 8.66inch
Total Height	225±3mm / 8.86inch

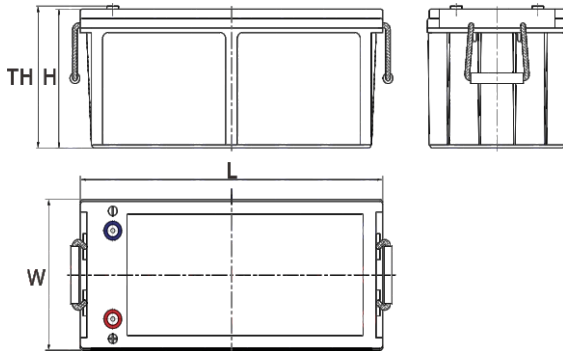

### Application

- ◆ Renewable energy system
- ◆ Hybrid solar power system
- ◆ Uninterrupted Power Supply (UPS)
- ◆ Communications and electric equipment
- ◆ Emergency lighting equipment
- ◆ Fire alarm and security systems
- ◆ Robots, control equipment, and other factory automation equipment
- ◆ Emergency power supply (EPS)
- ◆ Various power toy and hobby equipment
- ◆ Lighting equipment

### Terminal

Unit:mm

Terminal Type: I7

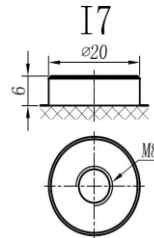

### Weight

63.2kg 139.33lbs



Merkez

100. Yıl Bulvarı 1232. Sokak  
(Eski 40. Sokak) No: 65  
Ostim / ANKARA



Tel&Fax

T. (0.312) 354 16 45  
(0.312) 385 55 60  
F. (0.312) 354 07 97



Servis

100. Yıl Bulvarı 1234. Sokak  
(Eski 57. Sokak) No: 91  
Ostim / ANKARA



Fabrika

Kırıkkale OSB Kızılırmak Caddesi  
4. Sokak No: 6  
Yahşihan / KIRIKKALE

# YALÇIN

# GOLD

## BATTERY

### Specificaion

<b>Nominal Voltage</b>	12V
	212Ah 20hr Rate(1.80V/cell)
	200Ah 10hr Rate(1.80V/cell)
<b>Rated Capacity(25°C)</b>	172Ah 5hr Rate(1.75V/cell)
	160Ah 3hr Rate(1.70V/cell)
	122Ah 1hr Rate(1.60V/cell)
<b>Container Material</b>	ABS (Flame-retardant ABS UL94-V0 is optional)
<b>Operating Temperature Range</b>	<b>Discharge</b> -20 ~ +50°C
	<b>Charge</b> 0 ~ +40°C
	<b>Storage</b> -15 ~ +40°C
<b>Capacity Effected by Temperature</b>	<b>40°C / 104°F</b> 106%
	<b>25°C / 77°F</b> 100%
	<b>0°C / 32°F</b> 86%
	<b>-10°C / 14°F</b> 65%
<b>Charge Voltage</b>	<b>Float Voltage</b> 2.25 -2.30V/cell@25°C, Tem. Coefficient: -3mV/cell/°C
	<b>Equalize Voltage</b> 2.35 -2.40V/cell@25°C, Tem. Coefficient: -3mV/cell/°C
	<b>Cycle Voltage</b> 2.40 -2.50V/cell@25°C, Tem. Coefficient: -5mV/cell/°C
<b>Max Charging Current</b>	60A (0.3C)
<b>Max. Discharge Current (5S)</b>	2000A
<b>Internal Resistance</b>	2.7mΩ
<b>Self Discharge</b>	<3%, YG series stored at 25 ° C require a supplementary charge every six months, the charging interval would shrink when the ambient temperature went higher

### Discharge Performance

Constant Current Discharge Table (25°C/77°F) Unit: A														
F.V/Time	10min	15min	20min	30min	45min	1h	2h	3h	4h	5h	6h	8h	10h	20h
1.85V/cell	273.1	235.4	200.7	151.9	114.5	94.28	60.09	46.2	37.6	31.3	27.2	22.10	18.9	10.5
1.80V/cell	337.4	277.0	231.3	176.1	133.2	105.58	65.49	50.6	40.6	33.6	29.2	23.40	20.0	10.6
1.75V/cell	370.6	296.3	245.4	185.6	138.3	110.48	67.98	52.0	41.7	34.5	30.0	23.80	20.2	10.7
1.70V/cell	404.0	316.4	259.0	192.7	143.7	113.97	70.68	53.5	42.7	35.3	30.6	24.20	20.4	10.9
1.65V/cell	435.9	336.4	276.0	200.7	147.3	117.77	72.68	55.8	44.2	36.3	31.3	24.70	20.8	11.0
1.60V/cell	467.3	359.7	291.9	211.9	153.6	121.97	75.08	57.5	45.5	37.3	32.0	25.10	21.0	11.1

Constant Power Discharge Table (25°C/77°F) Unit: W														
F.V/Time	10min	15min	20min	30min	45min	1h	2h	3h	4h	5h	6h	8h	10h	20h
1.85V/cell	504.5	439.3	378.4	289.4	217.1	179.35	115.0	88.84	72.37	60.44	53.02	43.21	37.44	20.400
1.80V/cell	615.8	510.0	429.7	330.5	250.5	199.76	124.6	96.73	77.79	64.58	56.68	45.68	39.54	20.600
1.75V/cell	665.8	538.8	451.4	345.5	257.5	208.04	128.8	99.09	79.57	66.26	58.07	46.38	39.94	20.700
1.70V/cell	709.2	567.2	472.8	356.6	266.8	213.96	133.7	101.66	81.44	67.64	59.16	46.97	40.24	21.100
1.65V/cell	758.4	598.5	500.2	368.6	271.0	219.58	136.6	105.50	83.91	69.22	60.25	47.96	41.04	21.400
1.60V/cell	794.4	629.5	523.3	386.3	281.0	226.18	140.5	108.26	86.08	70.99	61.34	48.56	41.44	21.500

 **Merkez**

100. Yıl Bulvarı 1232. Sokak  
(Eski 40. Sokak) No: 65  
Ostim / ANKARA

 **Tel&Fax**

T. (0.312) 354 16 45  
(0.312) 385 55 60  
F. (0.312) 354 07 97

 **Servis**

100. Yıl Bulvarı 1234. Sokak  
(Eski 57. Sokak) No: 91  
Ostim / ANKARA

 **Fabrika**

Kırıkkale OSB Kızılırmak Caddesi  
4. Sokak No: 6  
Yahşihan / KIRIKKALE

# YALÇIN GOLD BATTERY

## Discharge Characteristics

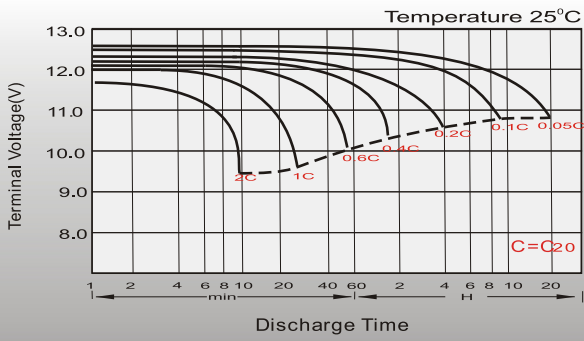

## Float Charging Characteristics

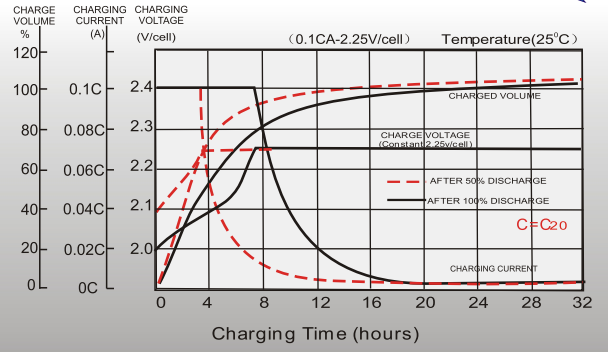

## Temperature Effects in Relation to Battery Capacity

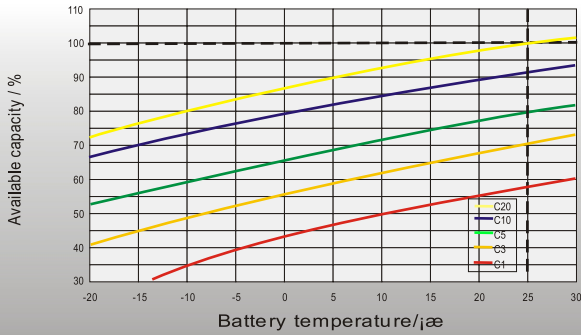

## Effect of Temperature on Long Term Float Life

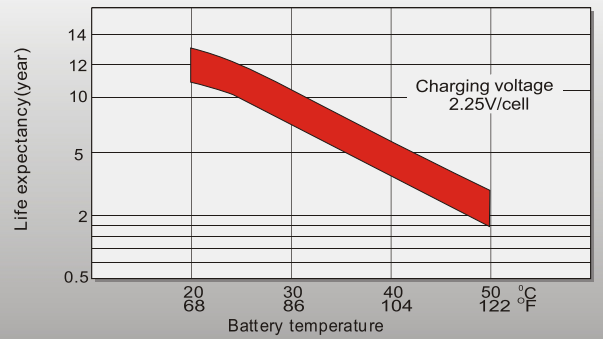

## Cycle Life in Relation to Depth of Discharge

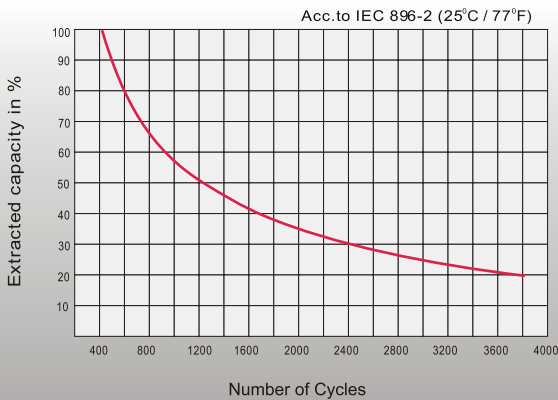

## General Relation of Capacity VS. Storage Time

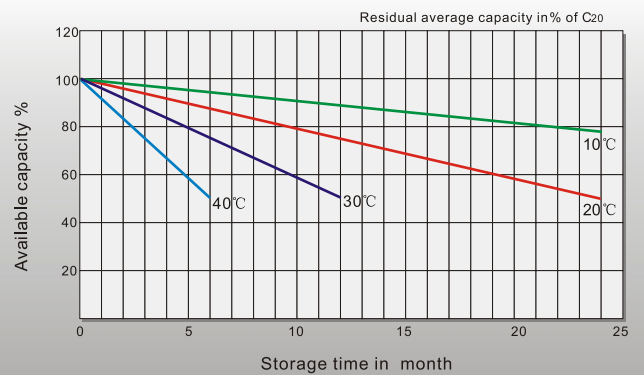

**Merkez**

100. Yıl Bulvarı 1232. Sokak  
(Eski 40. Sokak) No: 65  
Ostim / ANKARA

**Tel&Fax**

T. (0.312) 354 16 45  
(0.312) 385 55 60  
F. (0.312) 354 07 97

**Servis**

100. Yıl Bulvarı 1234. Sokak  
(Eski 57. Sokak) No: 91  
Ostim / ANKARA

**Fabrika**

Kırıkkale OSB Kızılırmak Caddesi  
4. Sokak No: 6  
Yahşihan / KIRIKKALE