

YALÇIN GOLD BATTERY

YGG12230.0 (12V230AH)

GENERAL FEATURES

- ◆ Oxygen recombination technology: maintenance-free, no need to add water or acid
- ◆ The patent grid alloy: less gassing, low self-discharge, excellent corrosion resistance
- ◆ Special paste formula: additives for deep discharge, long cycle life
- ◆ High quality AGM separator: extend cycle life and prevent micro short circuit
- ◆ The patent Nano silica electrolytes, extend cycle life and improve the deep discharge performance
- ◆ ABS container: increase the strength of battery (Flame-retardant ABS UL94-V0 is optional)

Dimension

Unit:mm

Length	522±2mm / 20.55inch
Width	238±2mm / 9.37inch
Container Height	218±3mm / 8.58inch
Total Height	224±3mm / 8.82inch

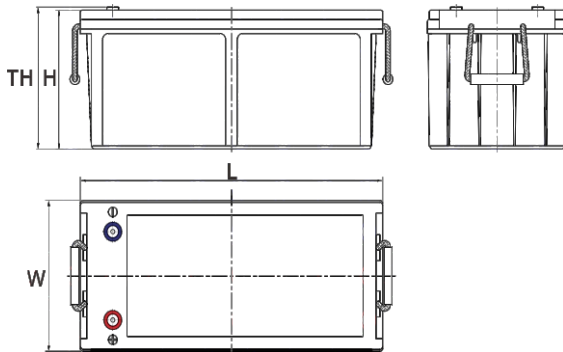

Application

- ◆ Renewable energy system
- ◆ Hybrid solar power system
- ◆ Uninterrupted Power Supply (UPS)
- ◆ Communications and electric equipment
- ◆ Emergency lighting equipment
- ◆ Fire alarm and security systems
- ◆ Robots, control equipment, and other factory automation equipment
- ◆ Emergency power supply (EPS)
- ◆ Various power toy and hobby equipment
- ◆ Lighting equipment

Terminal

Unit:mm

Terminal Type: I7

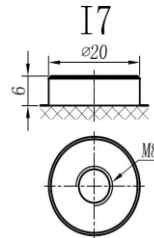

Weight

65.6kg 144.62lbs

Merkez

100. Yıl Bulvarı 1232. Sokak
(Eski 40. Sokak) No: 65
Ostim / ANKARA

Tel&Fax

T. (0.312) 354 16 45
(0.312) 385 55 60
F. (0.312) 354 07 97

Servis

100. Yıl Bulvarı 1234. Sokak
(Eski 57. Sokak) No: 91
Ostim / ANKARA

Fabrika

Kırıkkale OSB Kızılırmak Caddesi
4. Sokak No: 6
Yahşihan / KIRIKKALE

Specificaion

Nominal Voltage	12V	
	460Ah	20hr Rate(1.80V/cell)
	269Ah	10hr Rate(1.80V/cell)
Rated Capacity(25°C)	240Ah	5hr Rate(1.75V/cell)
	244Ah	3hr Rate(1.70V/cell)
	140Ah	1hr Rate(1.60V/cell)
Container Material	ABS (Flame-retardant ABS UL94-V0 is optional)	
Operating Temperature Range	Discharge	-20 ~ +50°C
	Charge	0 ~ +40°C
	Storage	-15 ~ +40°C
Capacity Effected by Temperature	40°C / 104°F	106%
	25°C / 77°F	100%
	0°C / 32°F	86%
	-10°C / 14°F	65%
Charge Voltage	Float Voltage	2.25 -2.30V/cell@25°C, Tem. Coefficient: -3mV/cell/°C
	Equalize Voltage	2.35 -2.40V/cell@25°C, Tem. Coefficient: -3mV/cell/°C
	Cycle Voltage	2.40 -2.50V/cell@25°C, Tem. Coefficient: -5mV/cell/°C
Max Charging Current	60A (0.3C)	
Max. Discharge Current (5S)	2250A	
Internal Resistance	2.6mΩ	
Self Discharge	<3%, YG series stored at 25 ° C require a supplementary charge every six months, the charging interval would shrink when the ambient temperature went higher	

Discharge Performance

Constant Current Discharge Table (25°C/77°F) Unit: A

F.V/Time	10min	15min	20min	30min	45min	1h	2h	3h	4h	5h	6h	8h	10h	20h
1.85V/cell	314.1	270.8	230.8	174.6	131.7	108.4	69.1	69.1	53.1	43.2	36.0	31.3	25.4	21.8
1.80V/cell	388.0	318.6	266.0	202.5	153.2	121.4	75.3	75.3	58.2	46.7	38.6	33.6	26.9	23.0
1.75V/cell	426.2	340.7	282.3	213.4	159.0	127.0	78.2	78.2	59.8	47.9	39.7	34.5	27.4	23.3
1.70V/cell	464.6	363.8	297.8	221.6	165.3	131.1	81.3	81.3	61.5	49.1	40.6	35.2	27.8	23.5
1.65V/cell	501.3	386.8	317.5	230.8	169.4	135.4	83.6	83.6	64.2	50.8	41.7	36.0	28.4	23.9
1.60V/cell	537.4	413.7	335.7	243.7	176.6	140.3	86.3	86.3	66.1	52.3	42.9	36.8	28.9	24.2

Constant Power Discharge Table (25°C/77°F) Unit: W

F.V/Time	10min	15min	20min	30min	45min	1h	2h	3h	4h	5h	6h	8h	10h	20h
1.85V/cell	314.1	270.8	230.8	174.6	131.7	108.4	69.1	53.12	43.23	35.99	31.28	25.41	21.76	11.884
1.80V/cell	388.0	318.6	266.0	202.5	153.2	121.4	75.3	58.18	46.68	38.63	33.58	26.91	23.02	11.999
1.75V/cell	426.2	340.7	282.3	213.4	159.0	127.0	78.2	59.79	47.94	39.67	34.50	27.37	23.25	12.115
1.70V/cell	464.6	363.8	297.8	221.6	165.3	131.1	81.3	61.51	49.09	40.59	35.19	27.83	23.48	12.346
1.65V/cell	501.3	386.8	317.5	230.8	169.4	135.4	83.6	64.16	50.82	41.74	35.99	28.40	23.94	12.461
1.60V/cell	537.4	413.7	335.7	243.7	176.6	140.3	86.3	66.11	52.31	42.89	36.80	28.86	24.17	12.576

Merkez

100. Yıl Bulvarı 1232. Sokak
(Eski 40. Sokak) No: 65
Ostim / ANKARA

Tel&Fax

T. (0.312) 354 16 45
(0.312) 385 55 60
F. (0.312) 354 07 97

Servis

100. Yıl Bulvarı 1234. Sokak
(Eski 57. Sokak) No: 91
Ostim / ANKARA

Fabrika

Kırıkkale OSB Kızılırmak Caddesi
4. Sokak No: 6
Yahşihan / KIRIKKALE